

CORD GRIP DATA SHEET

The **BRASS MALE CORD GRIP** can slide over the flex or cable and keep it secured in place with either a black or white plastic grub screw. The M10 external thread can then be attached to where it is required. Being a metal component it can be powder coated to match your fitting.

PRODUCT CODE [090-020-034](#)

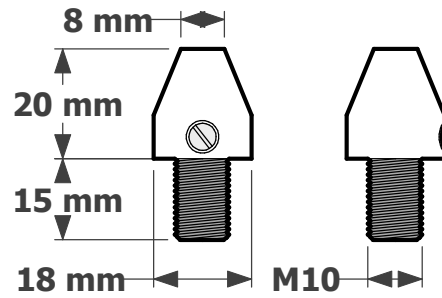

The **BRASS FEMALE CORD GRIP** can easily fit over the cable and keep it held into place with either a black or white plastic grub screw. Each end has an M10 internal thread allowing more options for it to be fitted.

PRODUCT CODE [090-020-030](#)

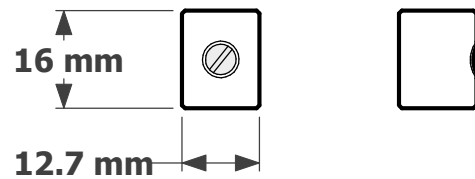

The **PLASTIC FEMALE CORD GRIP** is available in clear, black and white finish. The matching grub screw is then tightened against the cable to secure it in place. The M10 internal thread available for further attachments.

PRODUCT CODE [090-020-008](#)

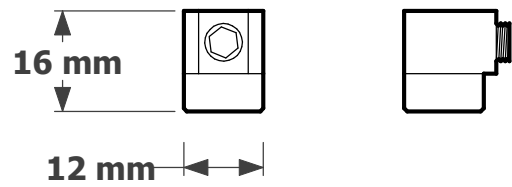

The **PLASTIC MALE CORD GRIP** is available in clear, black and white finish and can be locked onto the cable with the matching grub screw. With a M10 external thread for fitting off.

PRODUCT CODE [090-020-008](#)

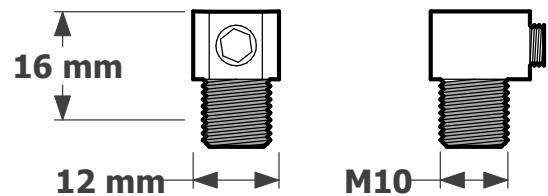

The **PLASTIC COLLET STYLE CORD GRIP** is available in black and white finish. The M10 thread can be used for further attachments.

PRODUCT CODE [090-020-009](#)

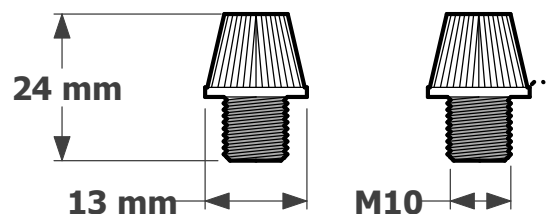

The **THREE HOLE CORD GRIP** is made in black nylon.

PRODUCT CODE [080-020-009](#)

ELETTRA
products

www.eletraproducts.com.au

Please remember to confirm the finish of your order and any customising that may differ from the data sheet.

sales@elettra.com.au