

WIRE CLAMPS

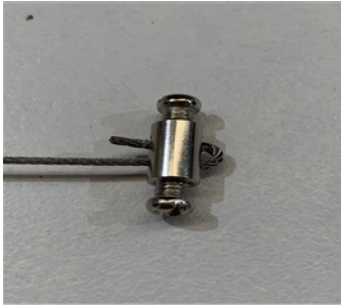

TWIN LOCK
PRODUCT CODE
090-020-003

The twin lock stainless steel wire lock is a double locking system that is suitable for heavy fittings.

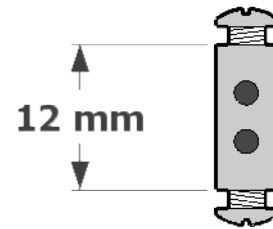

BASIC WIRE LOCK
PRODUCT CODE
090-020-010

This basic wire lock allows for the stainless steel wire to be treaded down through the centre of the adaptor and then locked into place using the M4 grub screw on the side. Supplied with a M10 thread for attaching.

Available in an extensive range of powder coats and finishes.

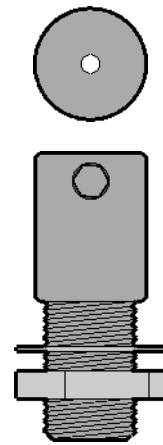

BASIC WIRE LOCK WITH ADJUSTMENT
PRODUCT CODE
090-020-006

This wire lock allows for the stainless steel wire to be treaded down through the centre and out the side of the adaptor and then locked into place using the M4 grub screw. Supplied with a M10 thread for attaching.

Available in an extensive range of powder coats and finishes.

